

F&ED BULLETIN

FALL 2021



THE UNIVERSITY
OF TEXAS AT DALLAS



Office of Facilities & Economic Development

SECTION	PAGE
Special Events	3
Campus Development	4
Economic Development	8
Department Updates	9



While much of The University of Texas at Dallas was evacuated when the COVID-19 pandemic first arrived in our country, the Office of Facilities & Economic Development didn't leave. We couldn't leave. There was too much campus infrastructure that needed to be maintained, and too many ongoing construction and facility improvement projects that couldn't be abandoned. F&ED also had the task of trying to prepare our campus for the "new normal" of a post-COVID world, whatever shape it might take.

This semester we welcomed our faculty and students back to campus, including some sophomores who've never been here before in person. While they were away, we've finished some major improvements to the University that everyone will enjoy.

The third phase of the Campus Landscape Enhancement Project (CLEP III) was finished just in time for the start of classes **[page 6]**. This phase brings more beauty, more shade and a more pedestrian-friendly environment to the University. The entire CLEP project was recognized by the University Economic Development Association **[page 8]**. As part of our landscaping changes, the Love Jack found a new home on the North Mall opposite the fountains of Texas Instruments Plaza **[page 3]** and was rededicated by UT Dallas administrators and Student Government.

Just a short walk across the street from campus, the final phase of Northside at UT Dallas, AKA "Comet Town", has been completed **[page 5]**, offering even more housing near UTD.

Even with the completion of those large, multi-year efforts, our work continues on projects both large and small. Several dining venues are being improved or replaced, such as The Market at the Naveen Jindal School of Management (JSOM), which was expanded to better serve a larger number of students **[page 4]**. Construction continues on the UTD DART Silver Line commuter rail station, which is on track to connect the University to DFW Airport and seven North Texas cities in 2024. Plans are now in progress for the construction of the Athenæum Arts and Performance Complex (APC) here on campus, and a Biomedical Engineering & Sciences Building (BMES) in the Dallas Medical District.

Looking towards the long-term future, our Economic Development team continues to work with surrounding municipalities that are trying to attract companies to the Metroplex, and is helping UT Dallas to partner with local businesses **[page 8]**.

We've endured through some trying times, and they're not over yet, but all of our staff are working hard to help The University of Texas at Dallas enjoy brighter days ahead.

*Dr. Calvin D. Jamison,
Vice President for Facilities & Economic Development*

ON THE COVERS

Two views of the new Pedestrian Promenade and surrounding landscaping, including rows of trees which will grow to shade the path.

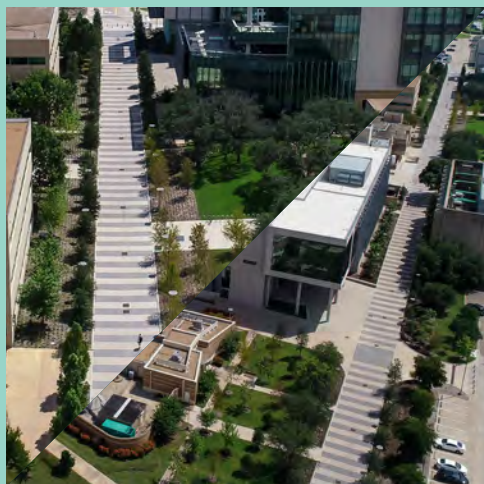



Above: Ryan Short, Student Government president; Rutendo Chando, previous Student Government vice president; Sara Brennan, previous Student Government president; Imaan Razak Macchiwalla, Student Government vice president.

Left: Sara Brennan and Rutendo Chando, outgoing Student Government president and vice president at the time of the re-dedication, cut a ribbon to officially open access to the Love Jack as University administrators look on.

Lower left: The sculpture's re-dedication plaque.

Below: Dr. Inga Musselman, vice president for academic affairs and provost; Dr. Rafael Martín, vice president and chief of staff; Dr. Richard C. Benson, president and Eugene McDermott Distinguished University Chair of Leadership; Dr. Calvin D. Jamison, vice president for facilities & economic development.

Rededicating the "Love Jack"

Forty-five years after Margaret McDermott gifted Jim Love's sculpture *Jack* to the University of Texas at Dallas, this massive modernist piece was relocated to a new place of prominence on our North Mall and rededicated by UTD administrators and members of Student Government.

Many of Love's sculptures can be found in the collections of the DMA, MFAH, MoMA and Whitney. This particular piece, created in 1971, first appeared at the University as part of a 1976 exhibit of contemporary art. The work has been moved around since joining the UT Dallas art collection, as new buildings and landscaping have reshaped our campus.

Generations of Comets have come to affectionately call this sculpture the *Love Jack*.

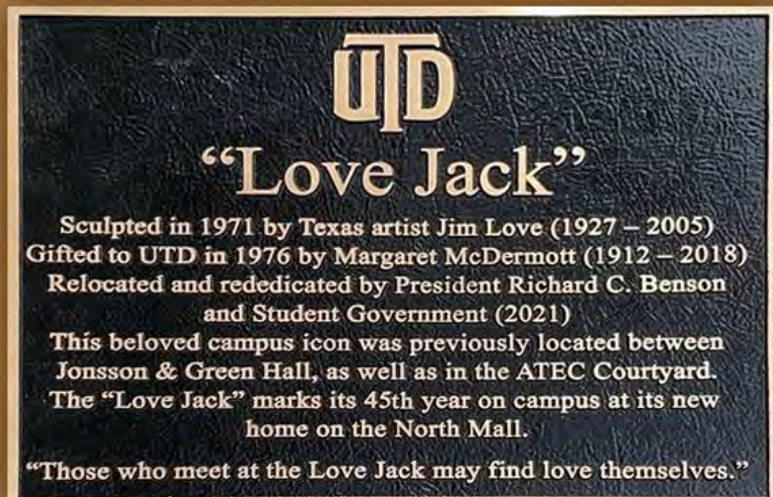



UTD DART Silver Line Station

Work continues on the UT Dallas station of the Dallas Area Rapid Transit (DART) Silver Line, a commuter rail service that will connect seven North Texas cities to DFW Airport and four other light rail lines. UTD's station will be one of ten stops along the 26-mile-long line, which will run from Shiloh Road in Plano to Terminal B at the airport. Rail service is expected to begin in 2024.

The Market at JSOM

Recent renovations to The Market at the Naveen Jindal School of Management (JSOM) were completed in time for it to return to serving on-the-go meals in the first week of the Fall semester. Located on the first floor off the building's rotunda, this venue was expanded to accommodate the larger number of students who pass through JSOM.



Biomedical Engineering Sciences Building (BMES)

Designs are being drafted for the new Biomedical Engineering & Sciences Building (BMES) in the Dallas Medical District. This joint UT Dallas and UT Southwestern facility will connect faculty from both institutions as they work to convert cutting-edge medical technologies into clinical applications. Four of the building's five floors will be dedicated to research laboratories. The rest of the space will be used for classrooms, conference rooms and offices. BMES will also become the new home of the Fabrication and Biodesign Center.

Athenæum Arts and Performance Complex

Plans are underway to develop the Athenæum Arts and Performance Complex (APC), an artistic hub for the University that will house the Edith O'Donnell Institute of Art History, the Wildenstein Library, the Museum of Art Popular in the Americas, performance and rehearsal spaces, and the newly-gifted Barrett and Crow art collections. The complex will likely be constructed off the circular drive at the intersection of University Parkway and Loop Road, just south of the Naveen Jindal School of Management (JSOM).

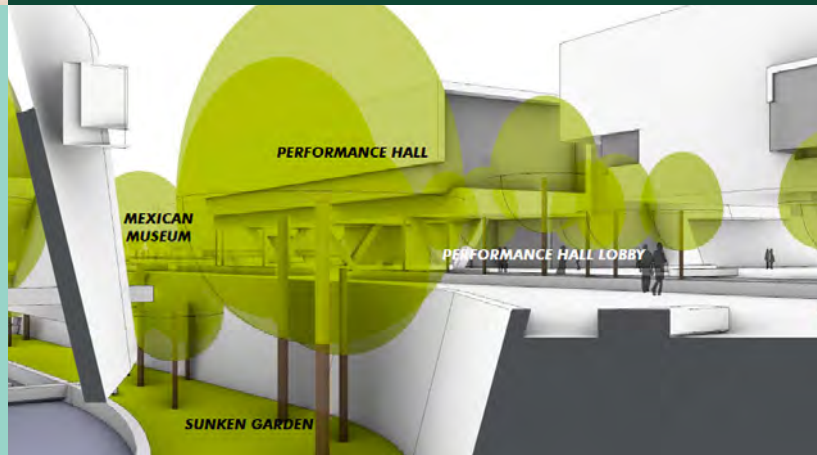



Comet Town is Complete!

The final phase of Northside at UTD Dallas, affectionately known as "Comet Town", opened this summer, providing the residential and retail complex with more outdoor recreation spaces, a basketball court, a third pool, a tree-lined plaza and open parkland. It also includes apartments that use smart home technology for controlling functions such as lighting and air conditioning from a smartphone. With the completion of this phase, Comet Town now offers 1,865 beds in 834 living units of various configurations across a 1 million gross square foot facility, sitting just across the street from campus and right next to the upcoming DART commuter rail station.





Campus Landscape Enhancement Project Phase III Completed

The \$18M third phase of the Campus Landscape Enhancement Project brought 1,200 new trees, numerous smaller plantings and a dramatic transformation to the UT Dallas campus. Completed just in time for the Fall semester, this phase made improvements to the Geology Corridor, to paths on the east side of Cecil H. Green Hall, to Facilities Way, to six different campus entrances and to the banks of Cottonwood Creek on the north end of campus. The largest change by far was the replacement of most of Rutford Avenue with a broad, tree-lined Pedestrian Promenade that now runs through the heart of campus.





Clockwise from upper left, opposite page:

A pair of benches sit in the shade of a new grove of trees planted between Callier Center Richardson and the Bioengineering and Sciences Building.

One of the many new stone signs greeting visitors to campus.

The south end of the Pedestrian Promenade.

Improved sidewalks and benches near Cecil H. Green Hall.

The wider, repaved Facilities Way has been given a sidewalk.

A new iron bridge connects the banks of Cottonwood Creek.

Light shines through the trees onto the new sidewalks, benches and display of samples in the east end of the Geology Corridor.

One of the many new plantings on campus.





UTD Recognized by UEDA

The University of Texas at Dallas was once again recognized by the University Economic Development Association (UEDA) at their last summit, when UTD was named a finalist in the “Place” category for its submission on the UT Dallas Campus Landscape Enhancement Project (CLEP). The special nature of this multi-year, \$70M endeavor caught the jury’s attention and helped promote the University to a wider audience. Dr. Calvin D. Jamison, vice president for facilities and economic development, had convinced donors to fund a project that was more than just landscaping, but sought to change the entire campus environment into a welcoming home for students, one that was conducive to creative thought and left a lasting impression on potential partners. These improvements also translated into concrete benefits: UT Dallas has attracted many more students since CLEP started, from 15,000 in 2008 to 30,000 in 2019.

UTD at the Richardson IQ

In February of 2022, five University of Texas at Dallas research centers will be launched in the official headquarters of the Richardson Innovation Quarter (Richardson IQ, or The IQ), at the historic “IQ at 1302” building, within the University’s new Centers for Emergent Novel Technology at the Innovation Quarter (CENT-IQ). Jenny Mizutowicz, manager of economic development initiatives, was part of the committee that reviewed which research teams would be granted part of the \$125,000 in seed grants from the Office of Research and installed at CENT-IQ. The selected groups represent a broad cross-section of cutting-edge scientific inquiry. Activity at the centers is expected to bring the power of UTD research to the local businesses that are currently in, and relocating to, The IQ. Mizutowicz believes “It’s a prime opportunity for UT Dallas to partner and interact with industry.”



Leveraging Relocations

As part of its work to help The University of Texas at Dallas become an economic engine for the region, F&ED’s Economic Development team helps local economic development organizations market their cities to companies considering relocating to North Texas. Jenny Mizutowicz, manager of economic development initiatives, often joins calls between cities and businesses to demonstrate how UT Dallas can address their particular needs. She has provided research on the region’s workforce and connected companies with University experts. Between potential partnerships, our workforce pipeline and research in a variety of fields, UTD can be an asset to any business considering relocating to the region.

Right: Northside at UT Dallas has been the site of many University partnerships.

Welcome Back!

Steve Lyles, associate director for facilities maintenance, was one of the many F&ED staff members who spent time during the first two days of school handing out water, helping students find their way to class and welcoming our Comets back to campus.



Retirements

This summer, Facilities Management held a cowboy-themed party in the Student Union Dining Hall to celebrate the contributions of two retiring staff members: Jay Silber, who leaves the Sign & Key Shop after 14 years of service; and Sam Eicke, who retires from Facilities Services after 34 years with the University.

From left: Virginia Smith, director of business & customer services; Doug Tomlinson, associate vice president for facilities management; Sam Eicke, recently retired associate director for facilities services; Jay Silber, recently retired director of the sign & key shop; Kelly Kinnard, assistant vice president for facilities services.



New Staff Members

Please welcome the newest members of the F&ED team:

Facilities Management

Sean Beacham
Zamareas Calhoun
Carlos Castro
James Johnson
Corey Lowe
Stephan Moore
John Nelson
Terrance Reed
Joseph Robinson
Cooper Sutton

Sustainability

Avery McKittrick

Administration

Shirley Dial

Economic Development

Cody Gibbs

Mail Services

Joshua Medina
Taylor Piering
Ryan Shaffer

Parking & Transportation

Jamison Lowman
Evan Ricks

Did You Know?

Portions of the UT Dallas campus are dedicated to the restoration of vegetation native to the Texas Blackland Prairie, which is both the habitat of many local pollinating insects and a waystation for migrating pollinators.



THE UNIVERSITY OF TEXAS
AT DALLAS

OFFICE OF FACILITIES
& ECONOMIC DEVELOPMENT

800 W CAMPBELL RD, AD 24
RICHARDSON, TX 75080-3021



fed.utdallas.edu